

**AAYUSHI MALIK DESIGNS**

1st Floor, B- 6 / 1, Commercial Complex, Balderjung Enclave, DELHI -110029  
 PHONE NO: 999967570  
 sayushimalkdesign@gmail.com

**GENERAL NOTES:**

ALL DIMENSIONS ARE TO BE READ AND NOT MEASURED.

ANY DISCREPANCIES MUST BE BROUGHT TO THE NOTICE OF THE ARCHITECT BEFORE EXECUTION AT SITE.

THIS DRAWING IS THE PROPERTY OF AAYUSHI MALIK DESIGNS AND IS NOT TO BE COPIED, REPRODUCED, HANDLED OVER TO A THIRD PARTY OR USED FOR ANY PURPOSE OTHER THAN FOR WHICH IT HAS BEEN ISSUED.

**LEGEND FOR ELECTRICAL**

SYN	PARTICULAR	QTY
01	15 AMP SOCKET WITH SWITCH (RAW POWER)	22
02	5 AMP POWER POINT FOR GUEST CHARGING	84
03	DATA SOCKET OUTLET (RJ-45)	14
04	25 % MW POWER CONDUIT	
05	25 % MW DATA CONDUIT	
06	CABLE TRAY SIZE 200X43 MM	15 MTR
07	DISTRIBUTION BOARD	

**PROJECT NAME:**

THE WEEKEND, NOIDA

**MEP CONSULTANT:-**

 WZ-47A, 1st Floor, Palam Ext. New Delhi-110045  
 Cont.No.-+91-9818870796  
 E-Mail- apnconsultant21@gmail.com  
 Web- www.apnconsultant.com

**DRAWING TITLE :**

EL - DATA CONDUIT LAYOUT

DRAWN BY : RAJESH

CHECKED BY : ARVIND SCALE : 1:50 A2

DATE - 10-06-2022

DRAWING NO. : LV-1 REVISION NO. :

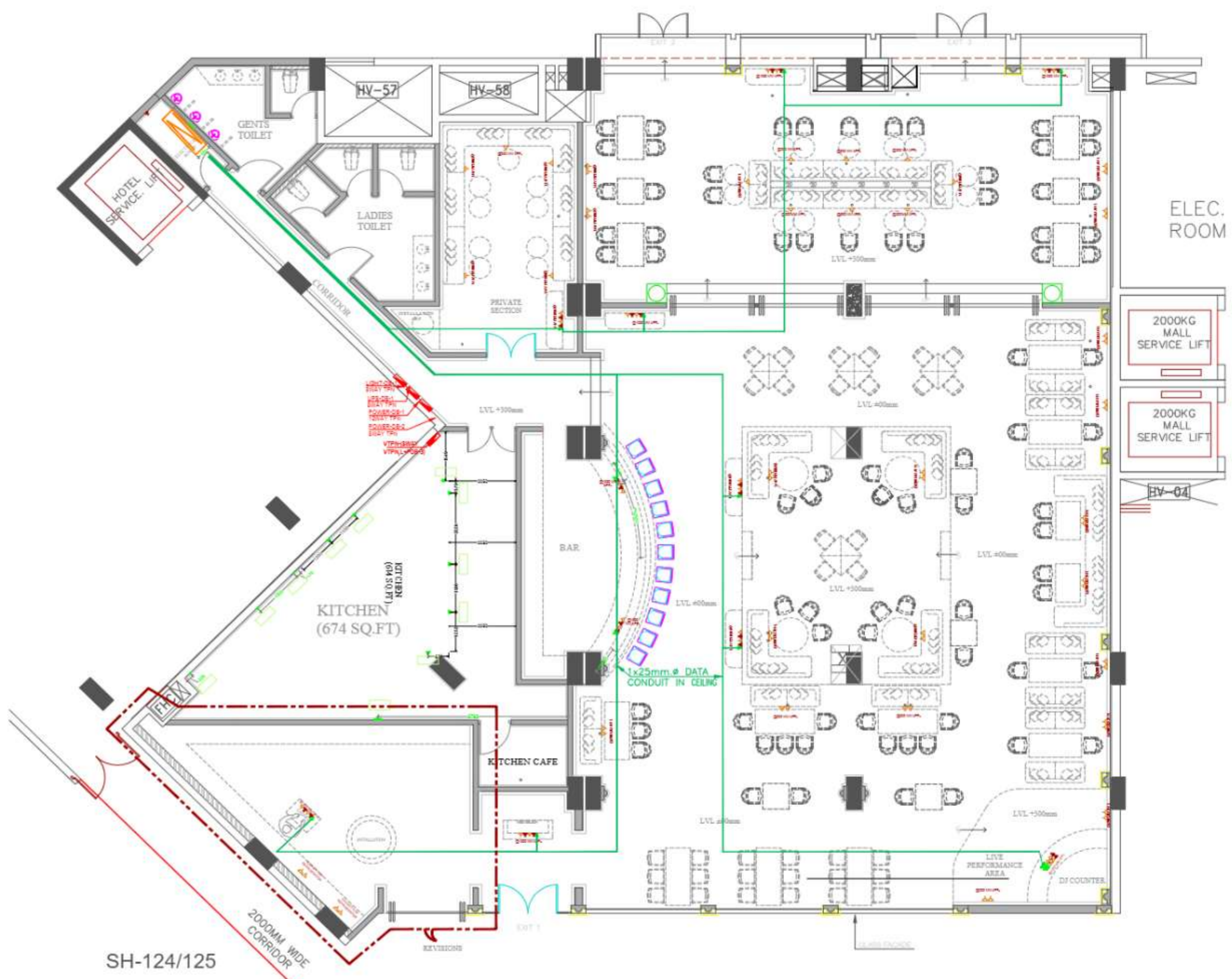

SH-124/125